



Mouseplane

Flush Trimming of Glue Lines and Wood



Mouse Plane eliminates tedious, heavy-duty sanding to remove dried glue or to level a wooden surface



High quality blade guard protects the sharp blade when not in use

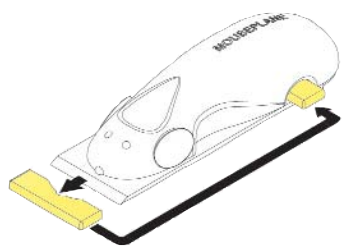

Handy storage compartment for blade guard when using the Mouse Plane



Replacement blades available

Changing the Mouse Plane blade is quick and simple, just unscrew the back, discard the old blade and replace with a new one then simply screw back in place

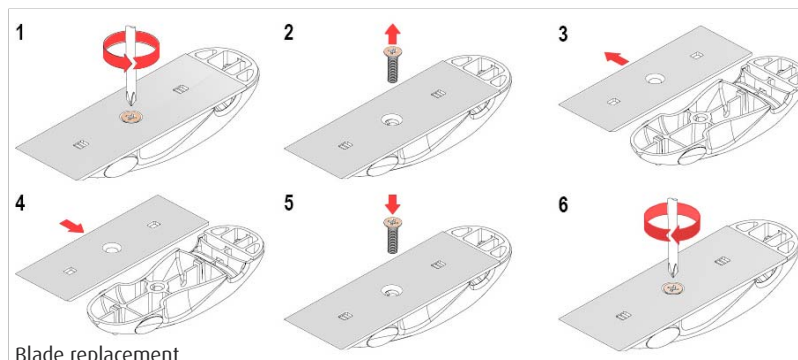

Blade replacement

- > Ideal for trimming off dried glue, to level wooden surfaces and for clearing out corners
- > Sits flush against the surface or edge
- > High quality carbon steel blade to maintain sharp edges, can be reground
- > Rounded shape fits comfortably in the hand for smooth application
- > Lightweight, yet robust
- > Comes with blade cover for safety and to protect the edge of the blade when not in use
- > Easy storage compartment for blade cover when using the plane
- > Blade can be unscrewed, and twisted round for added safety when stored



Kenyon Group Limited

Regent House, Regent Street, Oldham, Lancashire, OL1 3TZ
Telephone: ++44 (0) 161 627 1001 Facsimile: ++44 (0) 161 627 5072
www.gluegunsdirect.com

